

UP-HR150-6



Specification		
Nominal Voltage	6V	
Watts(15min Rate)	487.5 Watta at 1.67V/cell	
Dimension	Length	260±1mm (10.2 inches)
	Width	180±1mm (7.09 inches)
	Container Height	247±1mm (9.72 inches)
	Total Height (with Terminal)	253±1mm (9.96 inches)
	Approx Weight	Approx 21.2 kg (46.7lbs)
Terminal	T7	
Container Material	ABS	
Rated Capacity	155.0 AH/15.5A	(10hr , 1.80V/cell, 25°C/77°F)
	150.0 AH/18.75A	(8hr, 1.80V/cell, 25°C/77°F)
	131.0 AH/26.2A	(5hr, 1.75V/cell, 25°C/77°F)
	117.3 AH/39.1A	(3hr, 1.75V/cell, 25°C/77°F)
	101.3 AH/101.3A	(1hr, 1.60V/cell, 25°C/77°F)
Max. Discharge Current	1500A (5s)	
Internal Resistance	Approx 3mΩ	
Operating Temperature Range	Discharge: -15~50°C (5~122°F)	
	Change : 0~40°C (32~104°F)	
	Storage : -15~40°C (5~104°F)	
Nominal Operating Temperature Range	25±3°C (77±5°F)	
Cycle Use	Initial Charging Current less than 45.0A.Voltage. 7.2V~7.5V at 25°C(77°F)Temp. Coefficient -15mV/°C	
Standby Use	No limit on Initial Charging Current Voltage. 6.75V~6.9V at 25°C(77°F)Temp. Coefficient -10mV/°C	
Capacity affected by Temperature	40°C (104°F) 103%	
	25°C (77°F) 100%	
	0°C (32°F) 86%	
Self Discharge	Batteries may be stored for up to 6 months at 25°C (77°F) and then a freshening charge is required.	

Constant Current Discharge (Amperes) at 25°C (77°F)															
F.V/Time	5min	10min	15min	20min	30min	45min	1h	2h	3h	4h	5h	6h	8h	10h	20h
1.85V/cell	255.8	210.6	188.4	163.0	127.7	98.1	80.6	48.7	36.6	29.2	24.8	21.2	17.8	14.7	7.90
1.80V/cell	335.0	261.2	220.9	187.1	146.4	110.7	87.6	51.6	38.4	30.5	25.5	22.3	18.8	15.5	8.09
1.75V/cell	377.8	287.1	241.3	201.3	151.9	114.9	91.7	53.6	39.1	31.1	26.2	22.9	19.1	15.6	8.16
1.70V/cell	416.0	312.9	257.6	211.6	158.1	119.5	94.6	55.7	40.2	31.9	26.9	23.4	19.3	15.8	8.31
1.65V/cell	461.6	337.8	274.0	224.7	166.8	122.5	97.8	57.2	41.9	33.1	27.5	23.9	19.6	16.1	8.42
1.60V/cell	\	366.7	293.0	239.4	176.2	127.7	101.3	59.2	43.2	34.1	28.5	24.4	19.8	16.3	8.46

Constant Power Discharge (Watts) at 25°C (77°F)															
F.V/Time	5min	10min	15min	20min	30min	45min	1h	2h	3h	4h	5h	6h	8h	10h	20h
1.85V/cell	467.7	389.0	351.4	307.2	243.5	188.5	155.4	94.7	71.7	57.7	49.4	42.5	34.8	29.0	15.7
1.80V/cell	606.1	476.9	406.7	347.5	274.6	211.2	168.1	99.6	74.8	59.8	50.4	44.4	36.6	30.6	16.1
1.75V/cell	668.8	515.7	438.8	370.2	282.8	217.1	175.1	102.9	75.9	60.9	51.6	45.5	37.2	30.8	16.2
1.70V/cell	716.2	549.3	462.0	386.2	292.7	224.8	180.0	106.8	77.8	62.5	52.9	46.4	37.6	31.1	16.5
1.65V/cell	783.3	587.4	487.5	407.2	306.2	228.4	184.8	109.1	80.8	64.3	54.1	47.2	38.1	31.7	16.6
1.60V/cell	\	623.3	512.7	429.0	321.1	236.8	190.3	112.2	82.9	66.2	55.8	48.1	38.4	32.0	16.7



UP-HR150-6

Dimensions

■ T7 Terminal Unit: mm [inches]

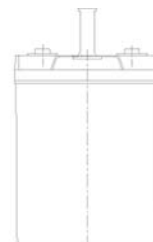
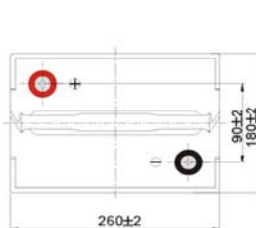
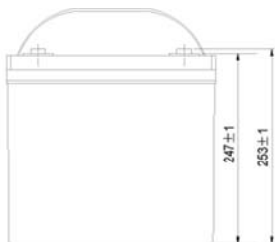
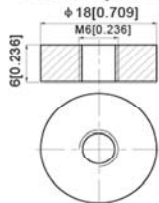

Discharge Characteristics

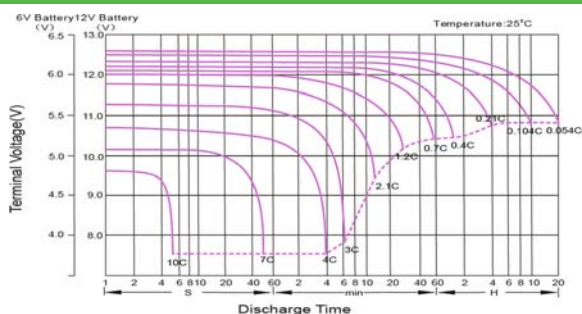

Temperature Effects in Relation to Battery Capacity

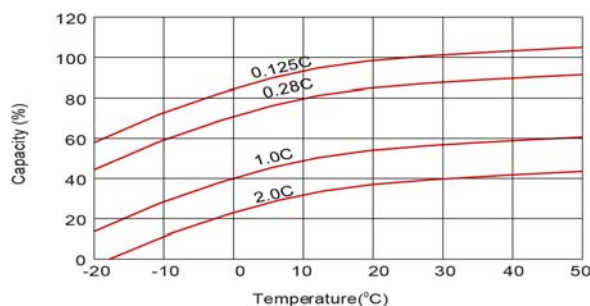

Float Charging Characteristics

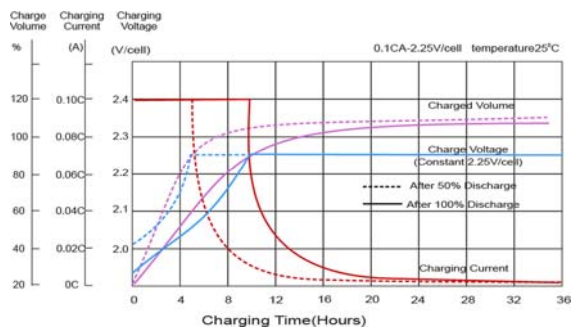

Effect of Temperature on Long Term Float Life

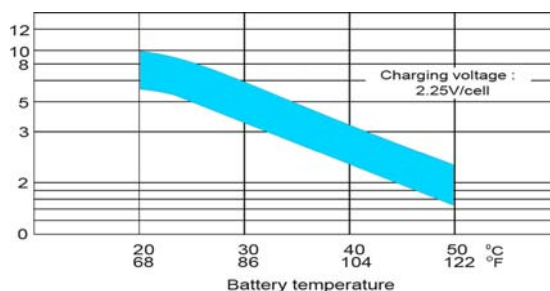

Self Discharge Characteristics

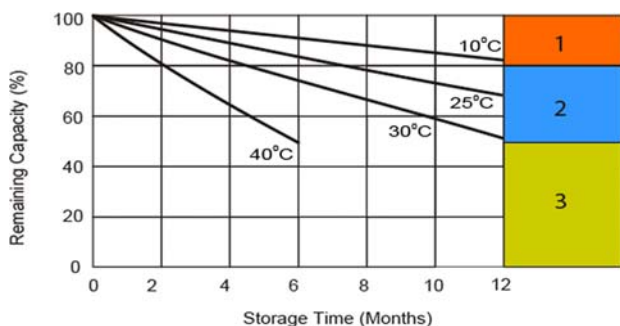

- 1** No supplementary charge required (Carry out supplementary charge before use if 100% capacity is required).
- 2** Supplementary charge required before use. Optional charging way as below:
 1. Charged for above 3 days at limited current 0.25CA and constant voltage 2.25V/cell.
 2. Charged for above 20 hours at limited current 0.25CA and constant voltage 2.45V/cell.
 3. Charged for 8-10 hours at limited current 0.05CA.
- 3** Supplementary charge may often fail to recover the capacity. The battery should never be left standing till this is reached.

